

Revolution of NON-Chemical  
**Green** Scale Control Technology

**SOFT-NO-R**

**GoodBye Water Softener...**

**WELCOME**

**SOFT NO R**



**Scale  
Of  
Fluid  
Treated  
NO Regeneration**

- Easy Installation and set up
- Long media life
- No Regeneration
- No Salt
- No Backwash
- No Electricity
- No Maintenance



**WATCH<sup>®</sup>**  
**ER**  
WATCH WATER  
*a Water Company*

### Introduction

Why always pollute water with Sodium using water softeners? Watch Water got a neat and clean chemical free scale prevention and corrosion prevention **FILTERSORB<sup>®</sup> SP3** media to convert hardness minerals to harmless inactive sub-micron crystals, making **SOFT-NO-R** series systems, the truly effective alternative technology to water softeners for the prevention of scale due to water hardness.

- **FILTERSORB<sup>®</sup> media does not remove healthy minerals or add sodium to the water supply.**

**SOFT-NO-R** systems can be installed as a pre-treatment to all reverse osmosis. No control valve, no electricity and no waste water - an absolute environmentally friendly “**GREEN**” technology. Simple sizing and installation - all you need to know is pipe size and the peak flow rate. Perfect systems for today and future for homes, towns and all communities where water softeners are banned. **SOFT-NO-R** systems are maintenance free; no salt bags or other chemicals to add constantly.

### Benefits:

- **Scale Prevention:** Scale deposits cause blocking and the failure of the water flow systems in household appliances (Washing machine, dish washer, coffee machine etc). A huge replacement cost for the pipes and the systems affected by the water hardness can be avoided using **WATCH<sup>®</sup> SOFT-NO-R** systems. The shower, faucets, bath and sinks are now without the trace of any scale and washed clothes are cleaner and have the softness and nice colours.
- **Hygiene:** **WATCH<sup>®</sup> SOFT-NO-R** scale prevention unit treated water is enriched with naturally occurred CO<sub>2</sub> in the water. The benefit & essence of CO<sub>2</sub> enriched water is medically proven, that helps with skin problems, lusterless hair and has many therapeutic applications.
- **Health:** Unlike any water-softening unit that works on the basis of ion-exchange, that takes out Calcium and Magnesium from the water and pollute it with unhealthy Sodium, **WATCH<sup>®</sup> SOFT-NO-R** scale prevention unit preserves the two essential minerals Calcium and Magnesium in the water. Thus making the water the best natural-mineral enriched drink available.
- **Economical:** **WATCH<sup>®</sup> SOFT-NO-R** scale prevention unit is very economical in the long run. Easy installation, easy setup, no power consumption, no drain, no backwash, no salt consumption, no chemicals and almost no maintenance is necessary.

### SOFT-NO-R System assembly:

**SOFT-NO-R** System is very easy to install. You save your time, money & maintenance costs. The main four components are 1) SK Head 2) Riser tube 3) Bottom Distributor & 4) Pressure Vessel

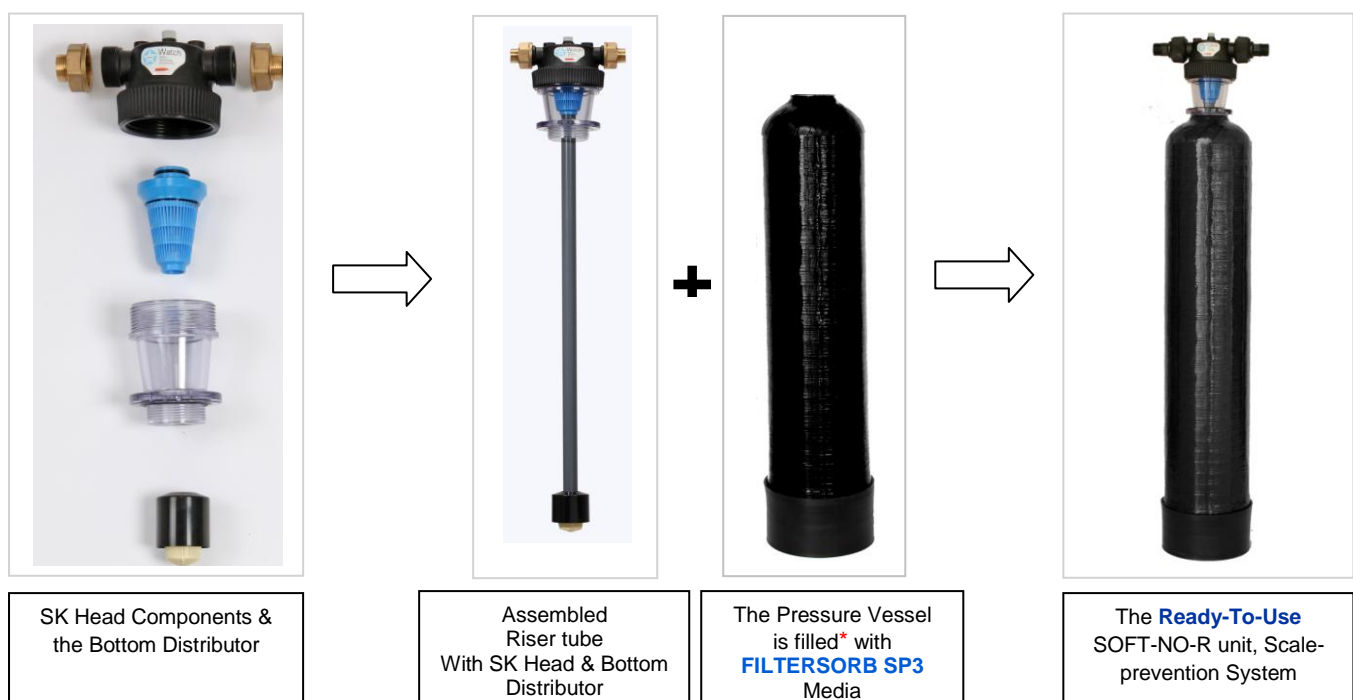

\* The amount of **FILTERSORB SP3** Media required is listed in **FILTERSORB SP3** Brochure

# SOFT-NO-R<sup>®</sup>, The Non-Chemical Scale Prevention System. No Salt, No Electricity, No Regeneration!

## How does SOFT-NO-R work?

WATCH<sup>®</sup> SOFT-NO-R uses revolutionary FILTERSORB<sup>®</sup> SP3 media inside a pressure vessel which is running in a counter current mode. The up flowing water causes the formation of a fluidized bed of the media. The immediate conversion of water hardness (due to Ca<sup>2+</sup> and Mg<sup>2+</sup>) gets converted into sub-micron size harmless crystal when hard water passes through the media. The height of the pressure vessel is chosen depending on the maximum flow rate of the unit, to provide the required space for the expansion of the floating bed. It's recommended to use a pressure vessels whose volume is 6 - 7 times than the volume of the media used.

- For example 3 liters of media(for hardness up to 450ppm with the flow rate 1 m<sup>3</sup>/h) would require the Pressure Vessel of dimension 8x35 (model: WATCH<sup>®</sup> SOFT-NO-R 1000)

The FILTERSORB<sup>®</sup> SP3 media completely takes care of the temporary water hardness, irrespective of the hardness level of the water\*. The average life expectancy of the media is around 3 - 5 years, depending on the water condition.

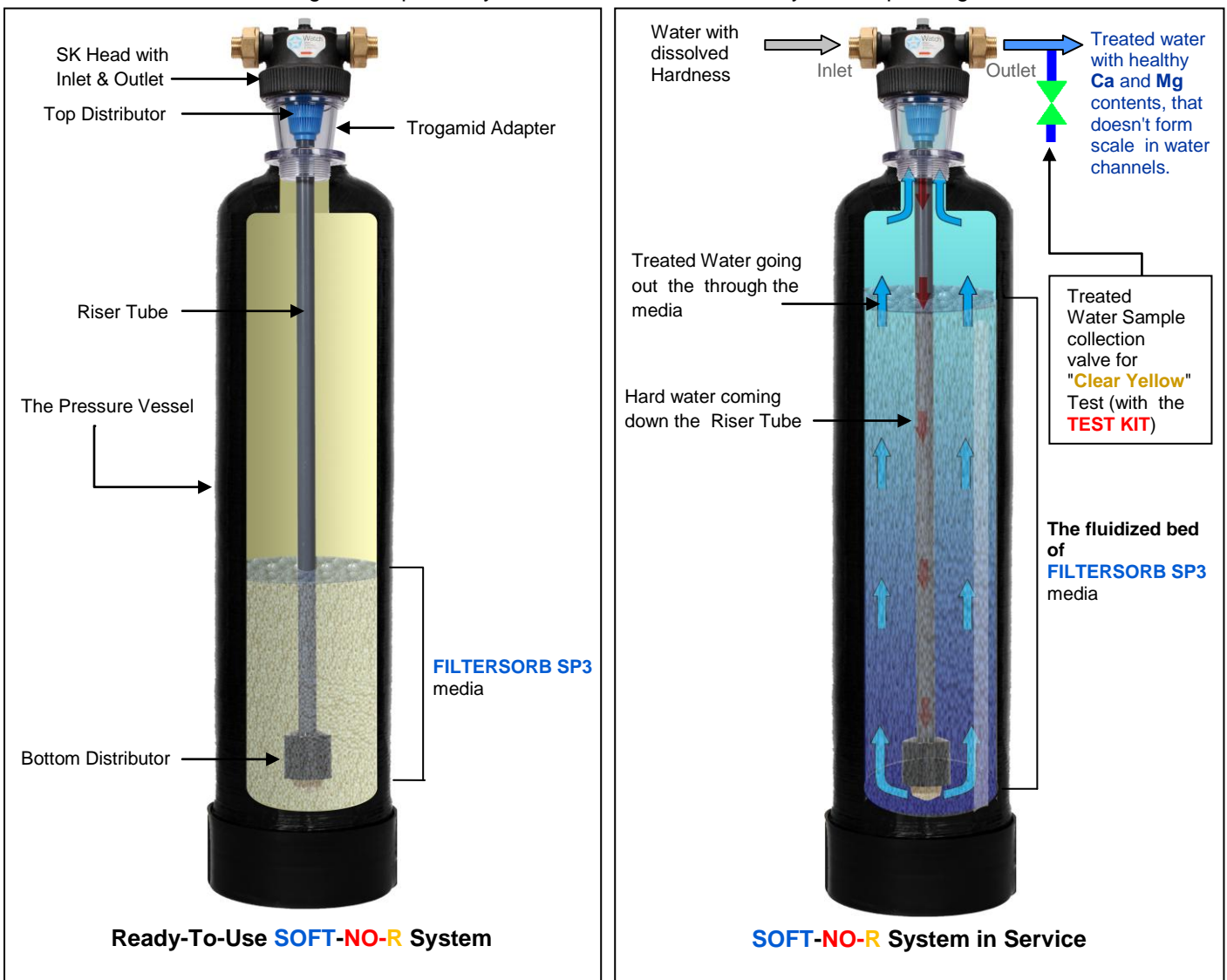

\*Water hardness up to 1340ppm (75gpg) is charted. Consult us to treat water hardness beyond 1340ppm.

## How to know if SOFT-NO-R unit is working properly?

For the first time in the water treatment industry, WATCH has developed the "TEST KIT" to check the performance of the media. One can simply test out the SOFT-NO-R's functionality using the "Clear Yellow" test. The sample water treated by the SOFT-NO-R system will show "clear yellow" when mixed with the testing reagent and that means the system is functioning optimal. It will show a turbid yellow if the media performance is declined.

- The performance of SOFT-NO-R unit's can be checked within a few minutes only.
- Only we have the "TEST KIT" !

# SOFT-NO-R<sup>®</sup>, The Non-Chemical Scale Prevention System. No Salt, No Electricity, No Regeneration!



## MORE FACTS REGARDING THE WATCH<sup>®</sup> SOFT-NO-R:

WATCH<sup>®</sup> SOFT-NO-R media, FILTERSORB<sup>®</sup> SP3 will be blocked if H<sub>2</sub>S, oil and grease are present in the water. There must not be any Iron and Manganese in the water (WHO conform). For 24hr per day operation we recommend a dual train unit. The SP3 media is heat resistant up to 120°C.

It's recommended to maintain a chlorine content up to 2ppm maximum.

UNIT Name	Flow rate (m <sup>3</sup> /h)	Flow rate (m <sup>3</sup> /h)		Type of Pressure Vessel	Pressure (bar)		Upper connection (male thread)	Max water temp
		min	max		min	max		
WATCH <sup>®</sup> SOFT-NO-R	500	0.4	0.5	07 x 17	1	10	SK ¾ Zoll	50°C
WATCH <sup>®</sup> SOFT-NO-R	1000	0.8	1.0	08 x 35	1	10	SK ¾ Zoll	50°C
WATCH <sup>®</sup> SOFT-NO-R	1500	1.2	1.5	08 x 44	1	10	SK 1 Zoll	50°C
WATCH <sup>®</sup> SOFT-NO-R	2500	2.0	2.5	10 x 44	1	10	SK 1 Zoll	50°C
WATCH <sup>®</sup> SOFT-NO-R	3000	2.4	3.0	10 x 54	1	10	SK 1 ¼ Zoll	50°C
WATCH <sup>®</sup> SOFT-NO-R	5000	4.0	5.0	12 x 48	1	10	SK 1 ¼ Zoll	50°C
WATCH <sup>®</sup> SOFT-NO-R	6000	4.8	6.0	13 x 54	1	10	SK 1 ¼ Zoll	50°C
WATCH <sup>®</sup> SOFT-NO-R	8000	6.4	8.0	14 x 65	1	10	LG 2 Zoll	50°C
WATCH <sup>®</sup> SOFT-NO-R	10000	8.0	10.0	16 x 65	1	10	LG 2 Zoll	50°C
WATCH <sup>®</sup> SOFT-NO-R	12000	9.6	12.0	18 x 65	1	10	LG 2 Zoll	50°C
WATCH <sup>®</sup> SOFT-NO-R	15000	12.0	15.0	20 x 72	3	10	LG 2 Zoll	50°C
WATCH <sup>®</sup> SOFT-NO-R	20000	16.0	20.0	24 x 72	3	10	LG 2 Zoll	50°C

\*Watch<sup>®</sup> provides solution for high capacity systems having a flow rate up to 100 m<sup>3</sup>/h. Please contact us for more information.

Watch<sup>®</sup> is a team of highly experienced specialists in Water Industry who provide new superior technologies compare to old conventional products.

Our experience and very successful products are unmatched in the industry and we have been recognized as an innovative industry leader. Watch<sup>®</sup> takes full responsibility in all kind of water treatment problems, with its innovative concepts and pragmatic solutions, geared with high-end bio-friendly water treatment chemicals and systems.



Watch Water<sup>®</sup> GmbH  
Fahrlachstraße 14  
D 68165 Mannheim

Telephone: +49 (0) 621 87951 0  
Fax: +49 (0) 621 87951 99  
Email: [info@watchwater.de](mailto:info@watchwater.de)  
Internet: <http://www.watchwater.de>